

USE FIGURED DIMENSIONS IN PREFERENCE TO SCALE  
ALL DIMENSIONS TO BE VERIFIED & CHECKED ON SITE

SCHEDULE OF BUILDINGS	
01	ADMINISTRATION
02	RESOURCE
03	SPECIAL EDUCATION
04	PREPATORY LEARNING
05A	JUNIOR LEARNING A
05B	JUNIOR LEARNING B
06	SENIOR LEARNING
07	CANTEEN & CENTRAL AMENITIES
08	MUSIC AND TECHNOLOGY
09	OUTSIDE SCHOOL HOURS CARE (OSHC)
10	CRECHE AND KINDERGARDEN
11	ANCILLARY
12	JUNIOR AMENITIES
13	SENIOR AMENITIES
14	SENIOR EDUCATION 02

**SITE PLAN LEGEND**

DPH DUAL PILLAR HYDRANT  
WT WATER TANK - REFER HYDRAULIC DRAWINGS

**NOTES**

1. REFER TO DRAWING 00-WD05 FOR FENCE TYPES.

NO.	ISSUE / AMENDMENT	DATE	INITIAL
1	TENDER ISSUE	13/03/09	PAJ

**JAMES CUBITT architects**

36 St Pauls Terrace  
Spring Hill  
Brisbane Qld 4000  
AUSTRALIA  
Ph +617 3831 7777  
Fx +617 3831 0777  
jca@cubitt.com.au  
www.cubitt.com.au

**Queensland Government**  
Department of Education, Training and the Arts

**AMBERLEY STATE SCHOOL RELOCATION**  
00 - SITE

Drawing Title:

SITEPLAN		
Designed PC	Drawn SPH	
Checked PC	Approved PC	
Scale 1:500 @ A1	Project no. 08927	
Date Plotted 13/03/2009	Dwg No. 00-WD02	Issue 1

**TENDER ISSUE**  
NOT FOR CONSTRUCTION

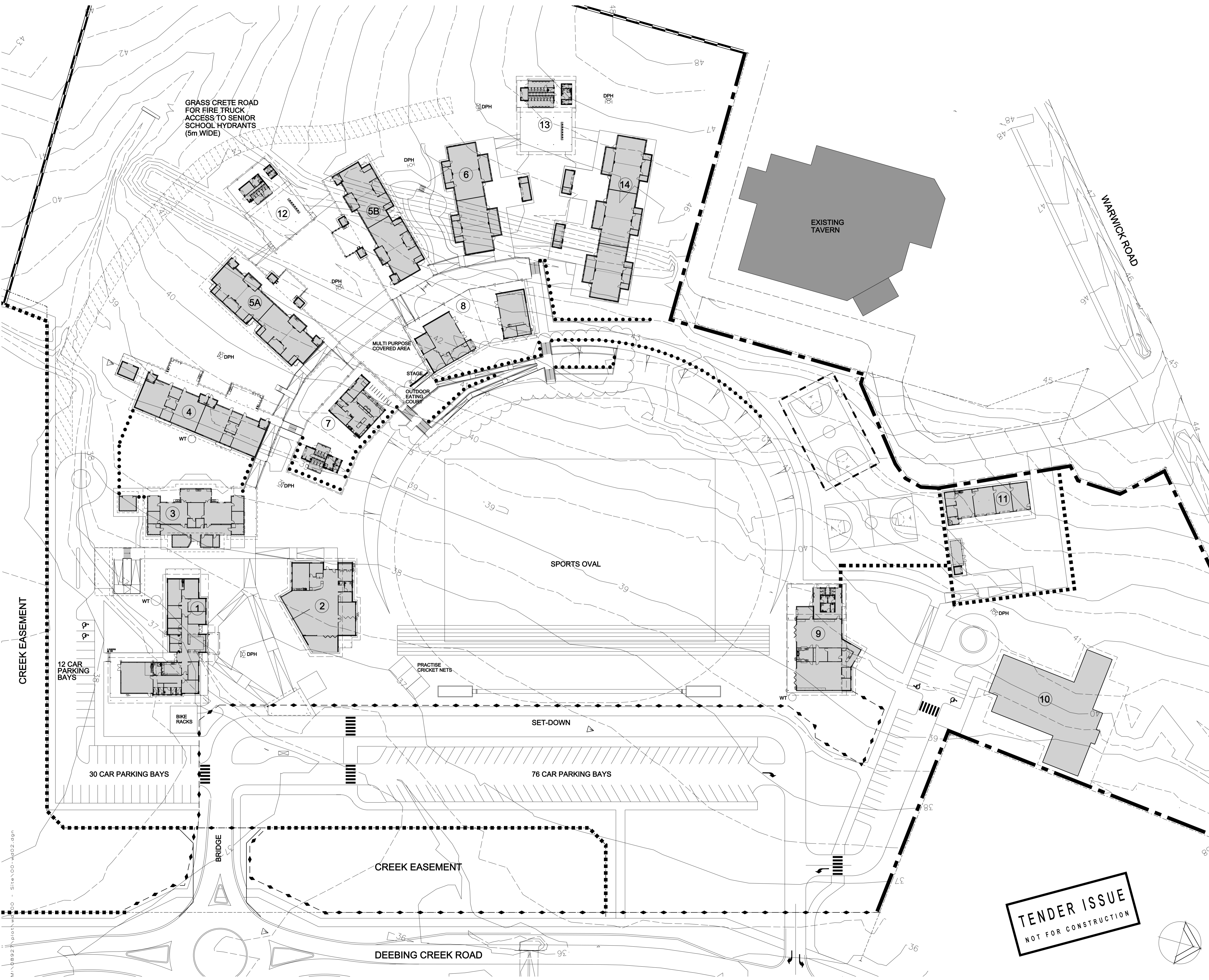
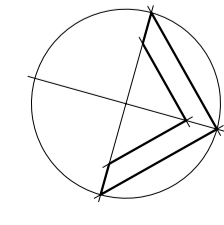

M:\08927\plot\w00 - Site\00-wd02.dgn